

MAY 10, 2019
KENNETH EVENSON, FACILITIES DIRECTOR
YUMA SCHOOL DISTRICT ONE

RE: **SFB ADJACENT WAYS SUBMITTAL**
 DOROTHY HALL ELEMENTARY SCHOOL

Mr. Evenson:

Thompson Design Architects and our engineering consultants have designed and prepared construction documents for the new Dorothy Hall Elementary School. McCarthy Building Companies is the general contractor and have prepared the attached Cost Estimate for SFB Adjacent Ways funding based on the construction plans.

Dorothy Hall Elementary School is a new 47,532 sqft K thru 5th grade elementary school. The project site is within a neighborhood subdivision and the site design includes bus and fire lanes, off-site utility and driveway infrastructure. The Adjacent Ways funding cost estimates submitted include fire line and fire lane sub-base, pavement, curbing and earthwork.

Please let us know if we can provide any additional information.

Sincerely,



Christopher Thompson
Principal Architect
Thompson Design Architects PC

Attachments:
McCarthy Cost Estimate Exhibit
Site Plan Exhibit

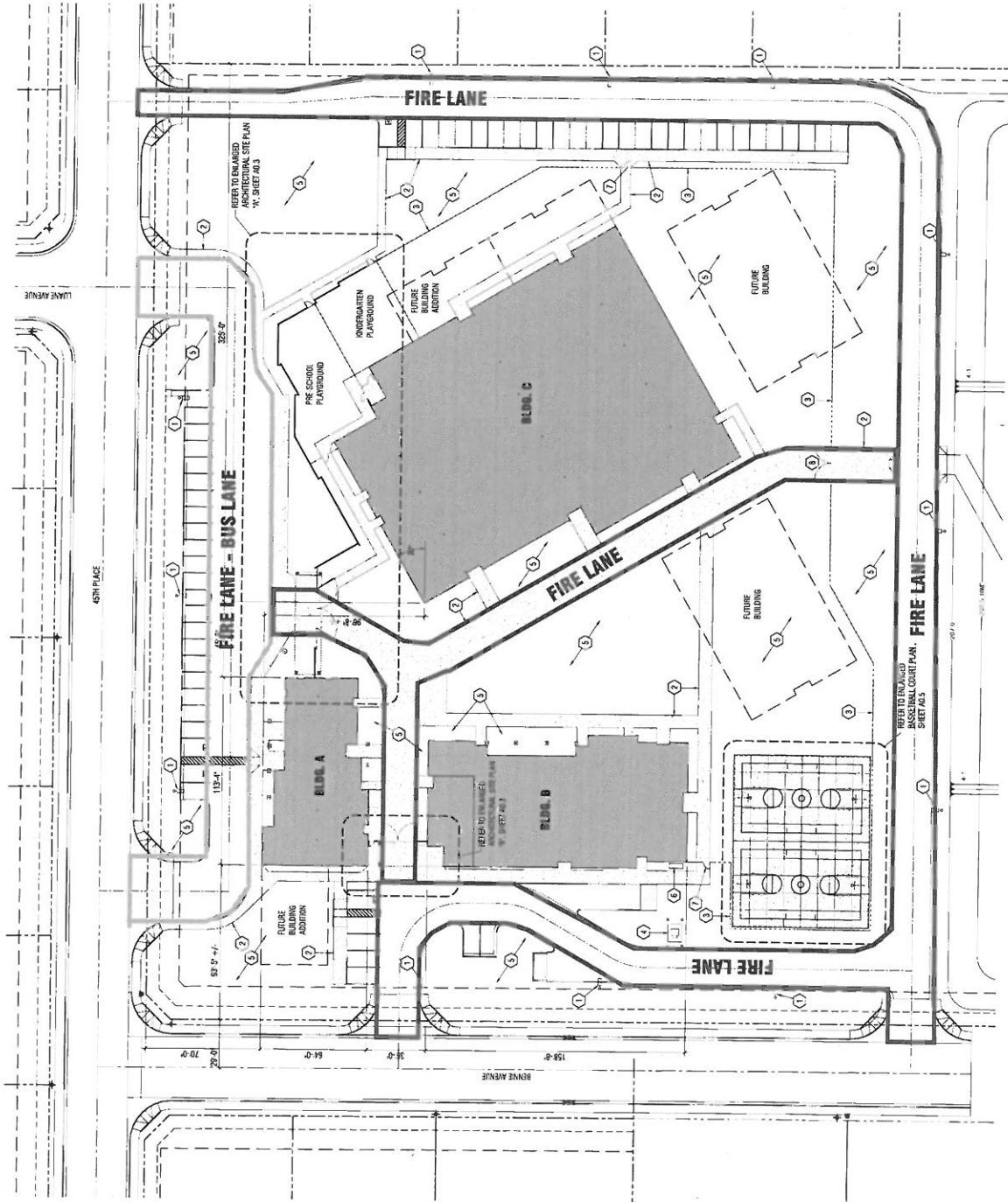

ENLARGED ARCHITECTURAL SITE PLAN
SCALE 1" = 30'-0"